

Design Illustration 1

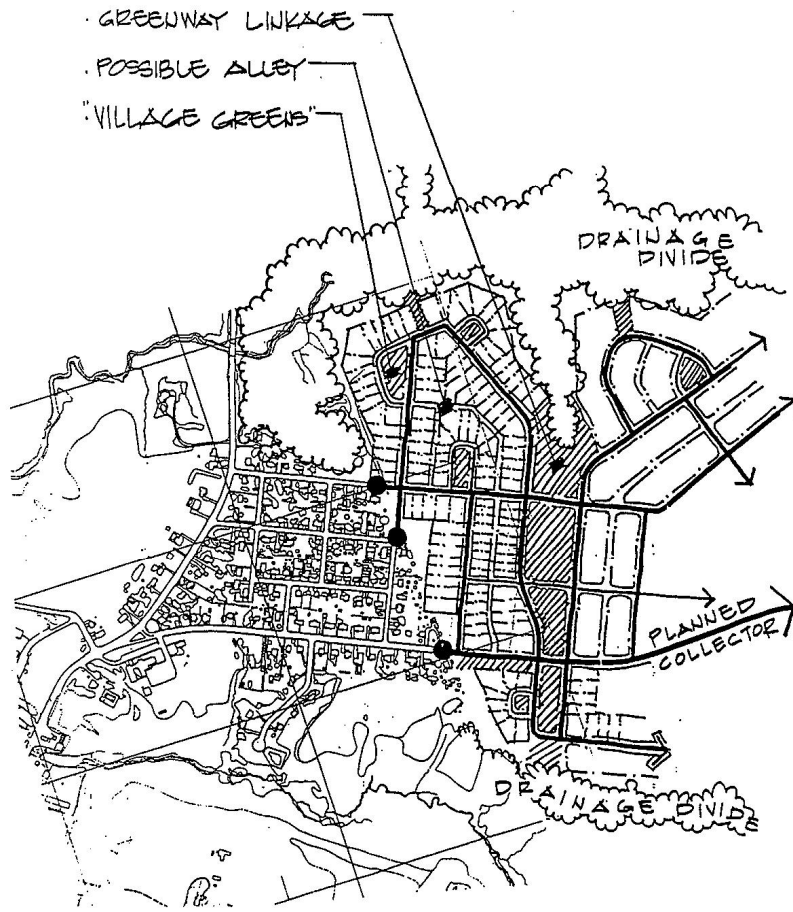

VILLAGE EXTENSION

Design Illustration 2

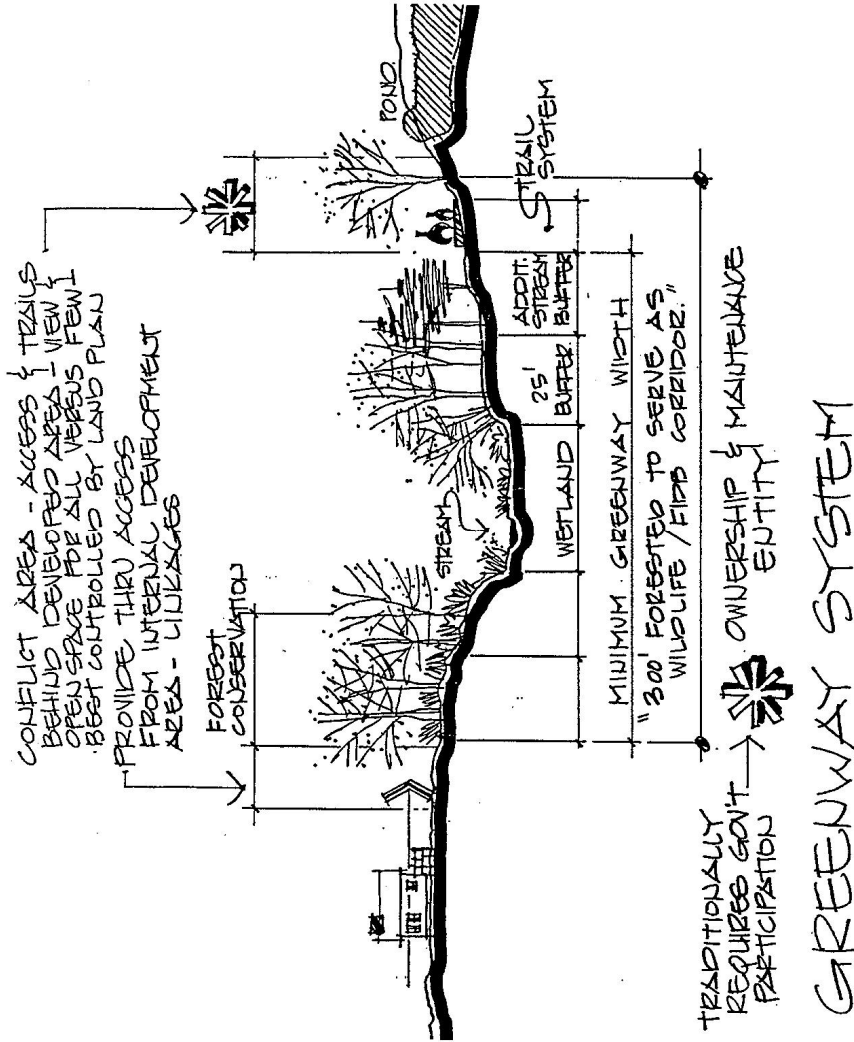

Design Illustration 3

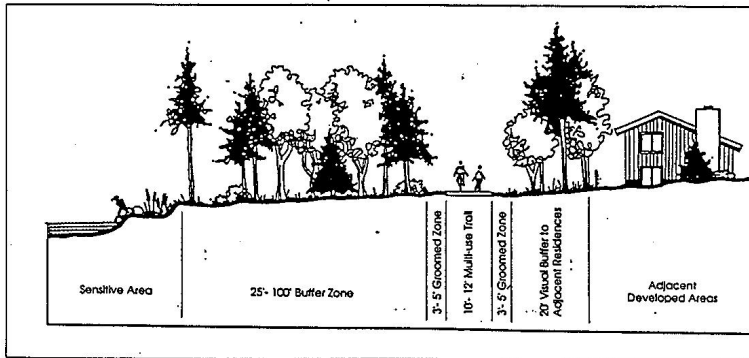
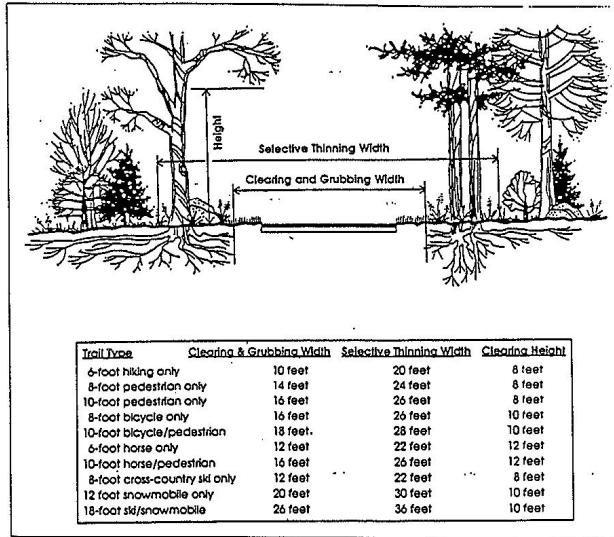

GREENWAYS

Design Illustration 4

- SIMILAR MODEL TO LOCAL RESIDENTIAL STREET.
- IF STREET TREES OMITTED FACADE TO FACADE SHOULD BE 50'-60'
- ON-STREET PARKING PREFERRED.

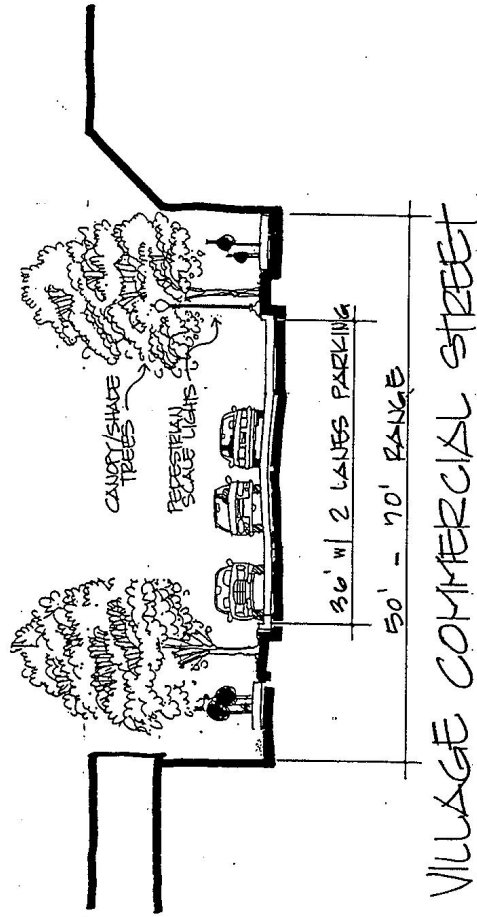

Design Illustration 5

: STREET CURBS CUTS ONLY
: BUILD IN PLACES

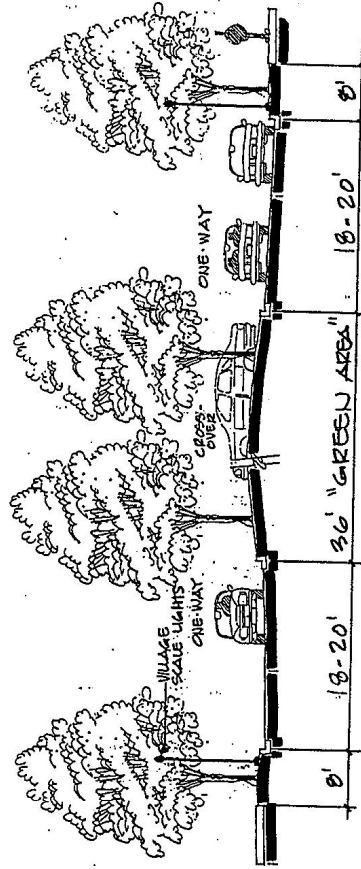

BOULEVARD TYPE STREET

Design Illustration 6

- COMPLETE LOSS OF STREET PRESENCE
- 4.5 : 1 WIDTH/HEIGHT RATIO
- NO EDGE DEFINITION
- EXPOSED, NO LANDSCAPE, SUBURBAN SCALE

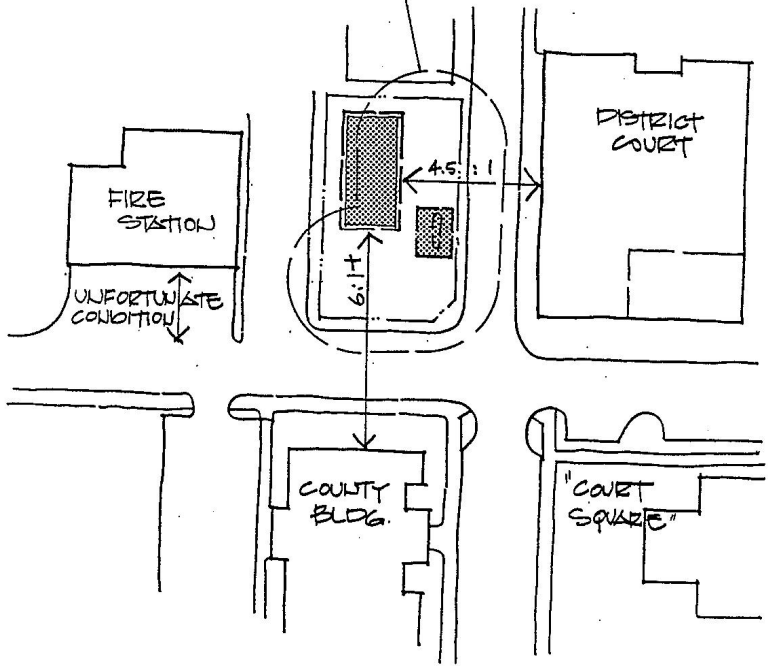

VILLAGE CORNER

Design Illustration 7

BETTER ...

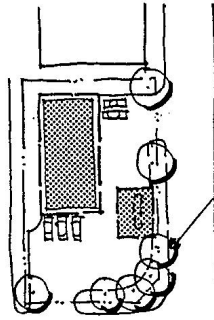

TREES,
WALLS
FORM
VISUAL
EDGE
CREATE
OUTDOOR
ROOM

IMPROVED ...

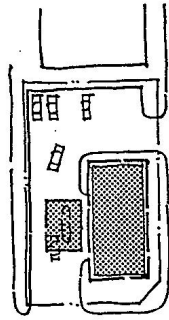
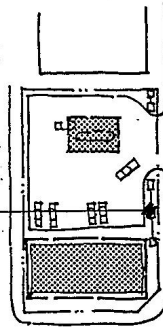

- BLDG RE-ESTABLISHES CORNER.
- VISUALLY UNPLEASANT USES TO BACK & SIDE

BEST ...

VILLAGE CORNER RE-DONE

Design Illustration 8

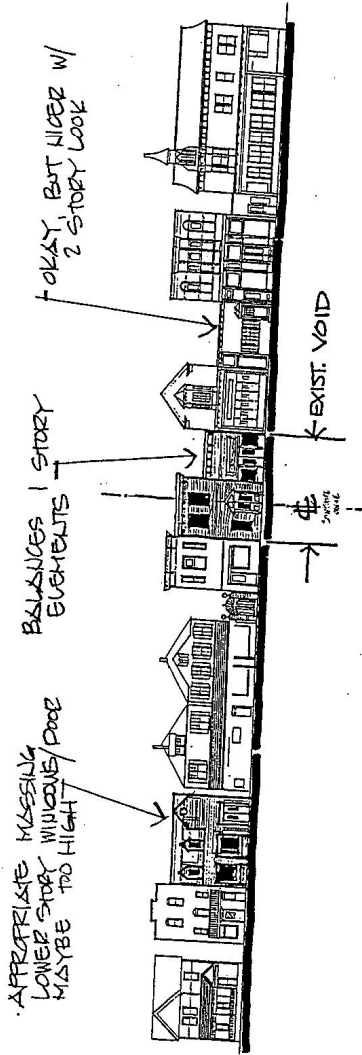

VIABLE SOLUTION

OPEN SIDES OF EX. BUDGS TO PEDESTRIAN PROMENADE

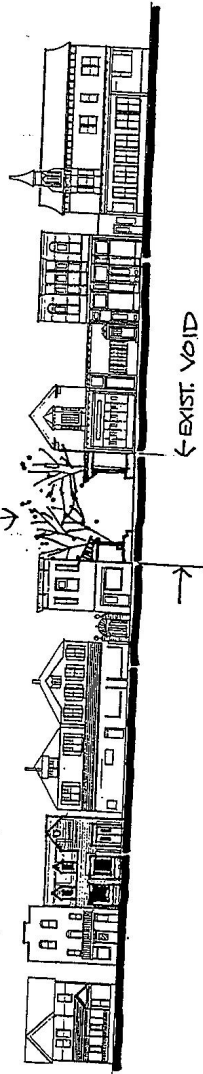

OPTION ...