

Design Illustration 9

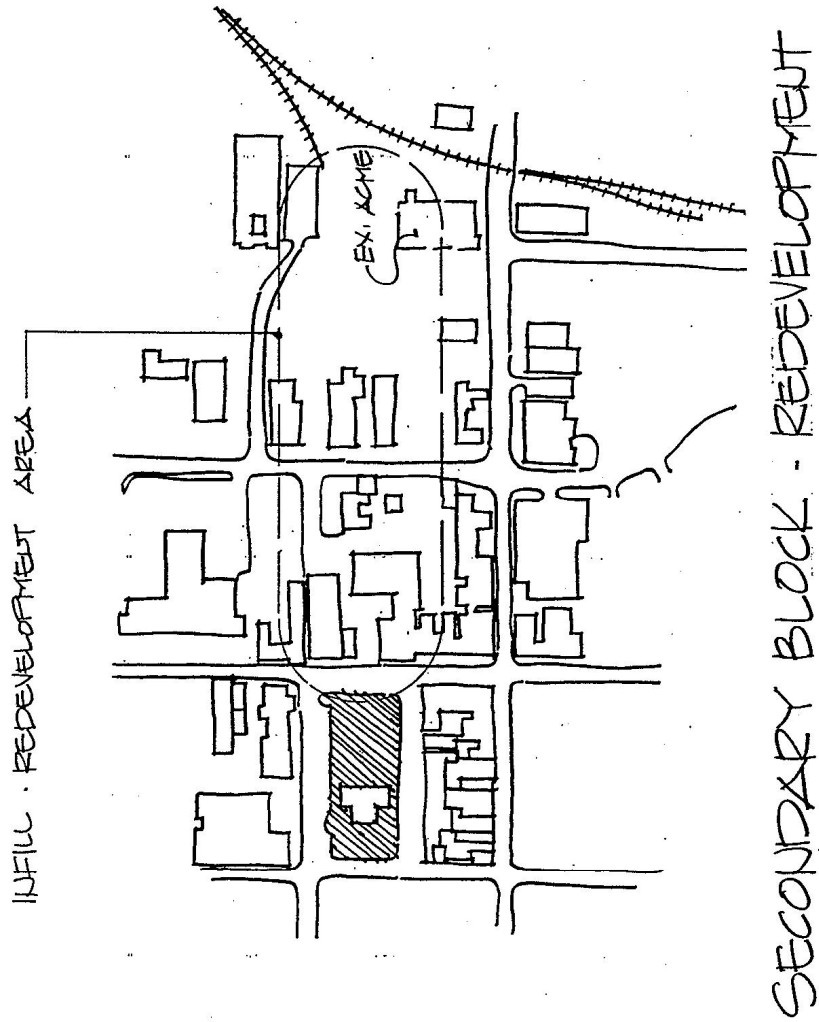

Design Illustration 10

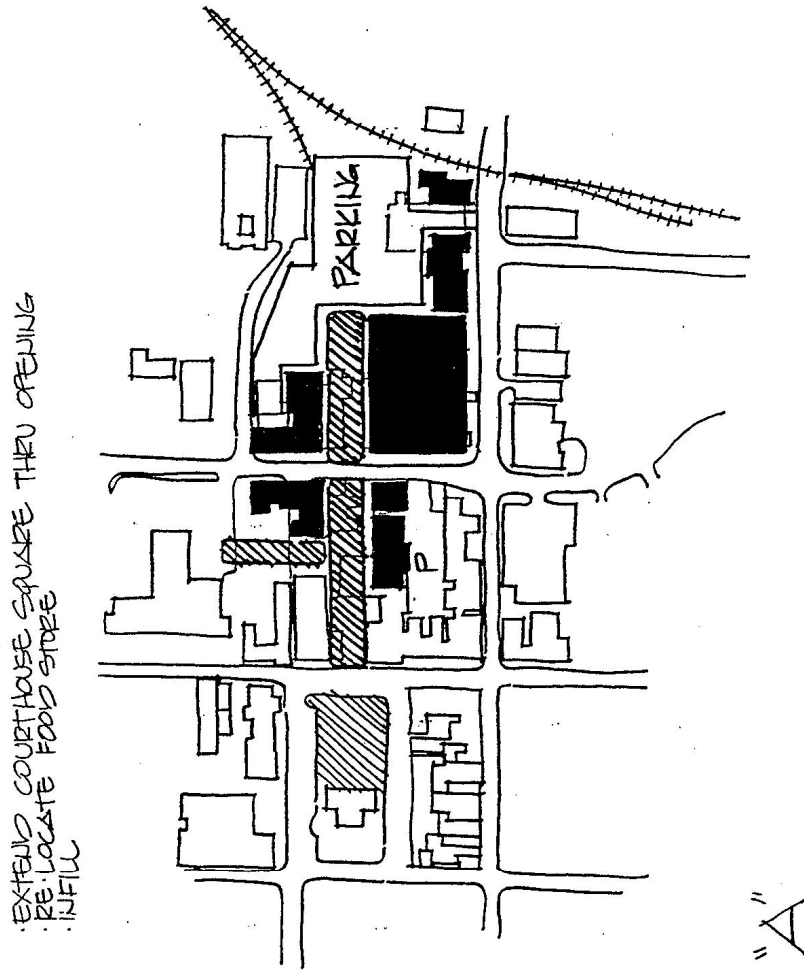

EXTEND COURTHOUSE SQUARE THRU OPENING
RE-LOCATE FOOD STORE
INFILL

"A"

Design Illustration 11

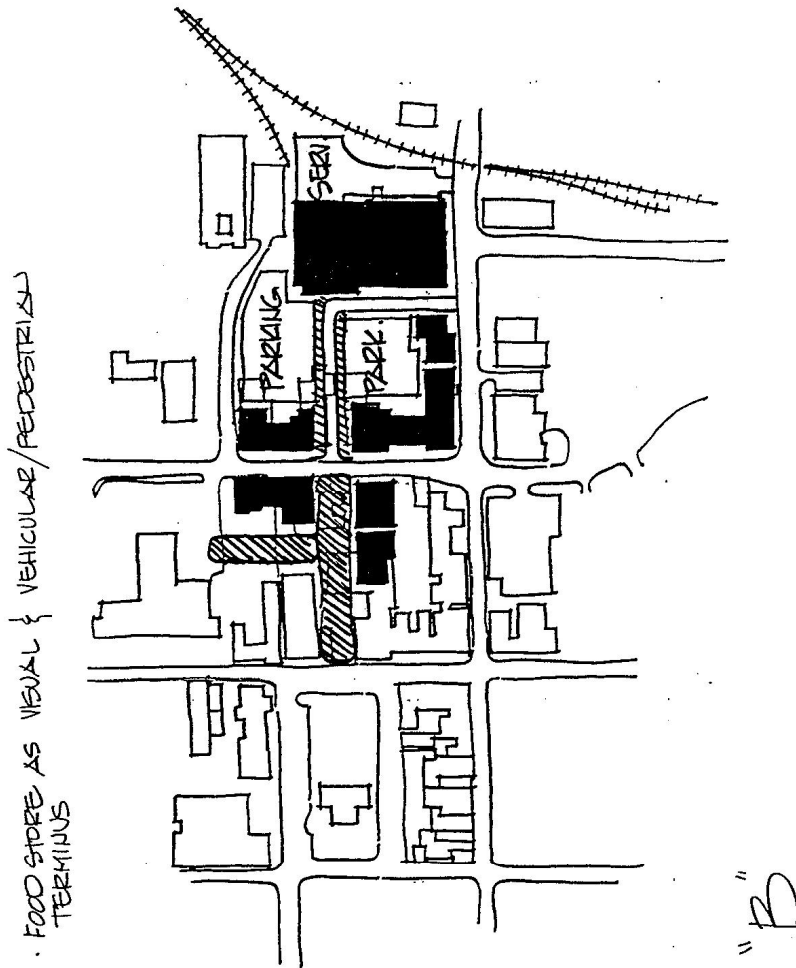

Design Illustration 12

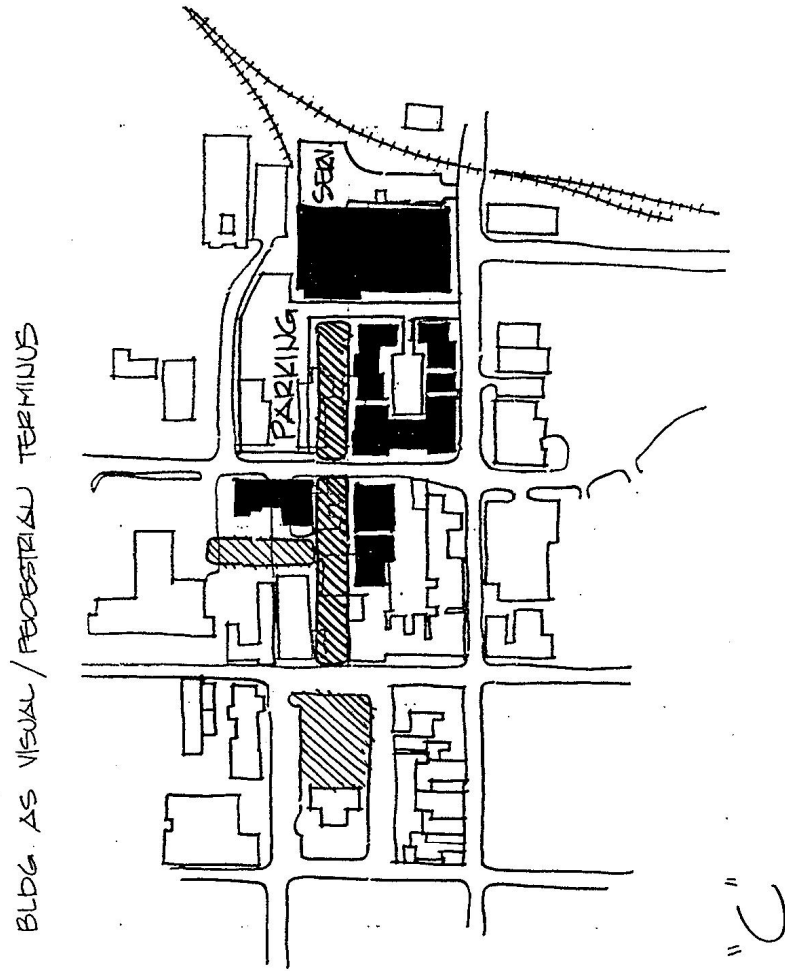

Design Illustration 13

FOOD STORE NOT VISIBLE FROM MAIN STREETS

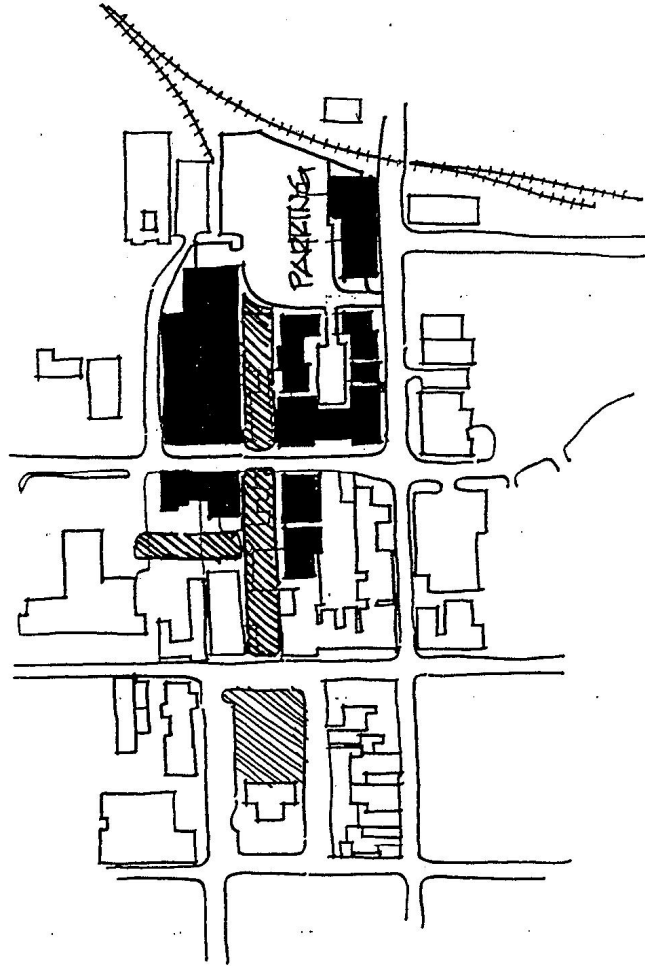

"D"

Design Illustration 14

**CENTREVILLE WHARF
SITE PLAN CONCEPT.**

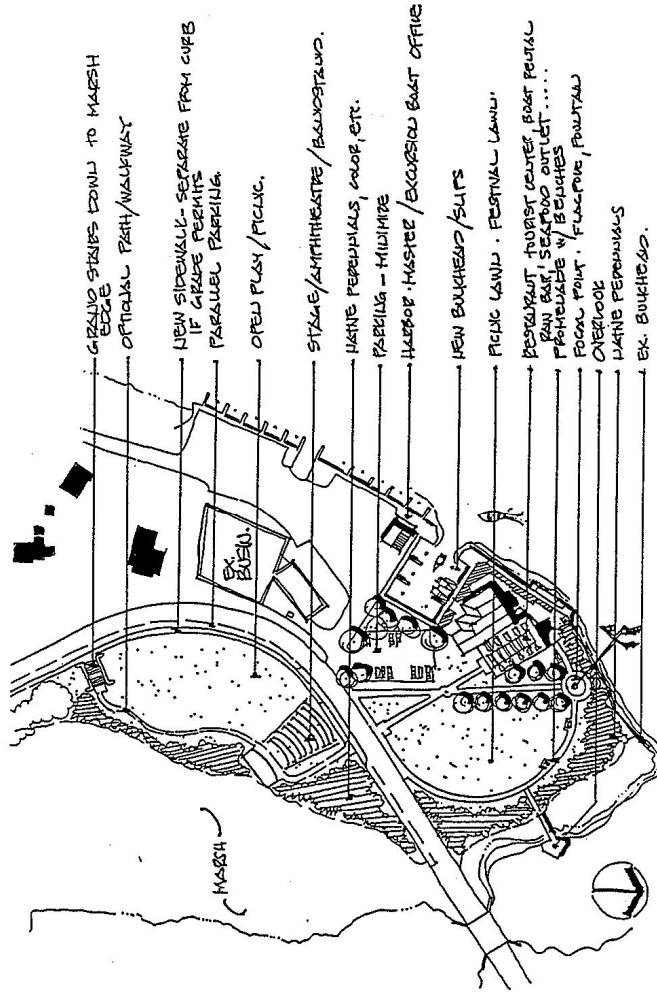

GRADING STRIP EDGES TO MARSH
OPTIONAL PATH/WALKWAY

NEW SIDEWALK - SEPARATE FROM CURB
IF GRABE PERMITS
PARALLEL PARKING

OPEN PLAY / PICNIC

STAGE / AMPHITHEATRE / BASKETBALL

WATER PERENNIALS, COLOR, ETC.

PARKING - MULTIPLE

HARBOR - MARSH / EXCAVATED BOAT OFFICE

NEW BUILDING / SUITS

PICNIC LAND - FESTIVAL LAND

RESTAURANT - TOURIST CENTER, BOAT RENTAL
PANTRY, SEAFOOD OUTLET, ...

PROBABLE W/ BEACHES

FOCAL POINT - FOUNTAIN, FOUNTAIN

OVERLOOK

WATER PERENNIALS

EX. BUILDING

Design Illustration 15 ROUTE 304

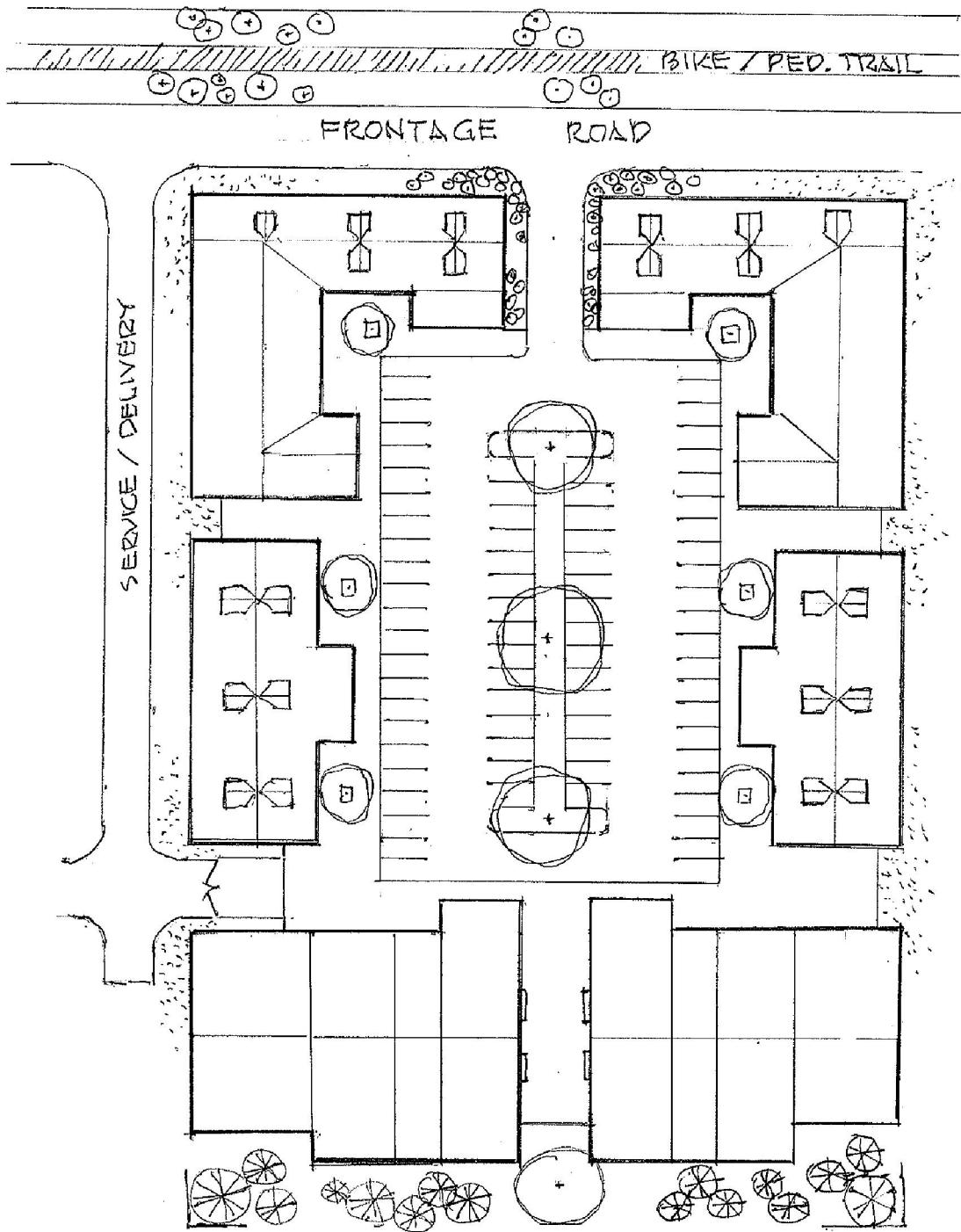

MIXED USE CORRIDOR CONCEPT
SITE PLAN 1" = 60' ±

Design Illustration 16

